

SALEM LOCAL PLANNING AREA

SALEM - BANGALORE ROAD DETAILED DEVELOPMENT PLAN PART II

MAP NO. 485

LEGEND	
	DETAILED DEVELOPMENT PLAN BOUNDARY
	WARD BOUNDARY
	BLOCK BOUNDARY
	EXISTING ROADS STREETS AND LANES
	PROPOSED ROADS AND STREETS TO BE FORMED BY L.P.A
	PROPOSED ROADS AND STREETS TO BE FORMED BY OWNERS BE MADE BY L.P.A.
	PROPOSED WIDENING OF EXISTING ROADS AND STREETS TO BE MADE BY L.P.A.
	PROPOSED WIDENING OF EXISTING ROADS AND STREETS TO BE MADE BY OWNERS.
	RESERVED FOR PUBLIC PURPOSES
	RESERVED FOR COMMERCIAL PURPOSES
	RESERVED FOR CONTROLLED INDUSTRIAL AREA
	RESERVED FOR POOR CLASS AREA

BUILDING LINE
 UP TO 20' (6.34 M) ROADS
 FROM 30' (9.14) UP TO 40' (12.19) 100' (30.5)
 FROM 50' (15.25) UP TO 75' (22.86) 150' (45.7)
 80' (24.4) ROADS AND ABOVE 200' (61.0)

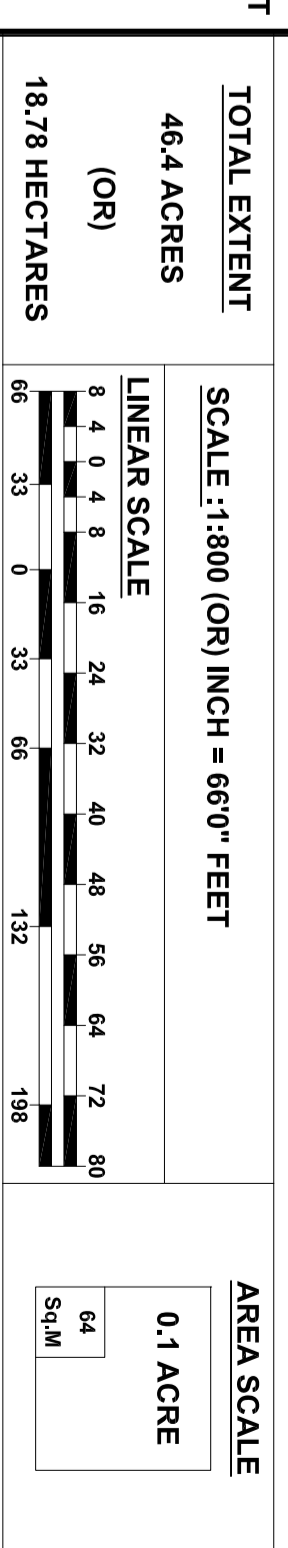

MEMBER SECRETARY (I.C.),
 SALEM LOCAL PLANNING AUTHORITY,
 SALEM.

REGIONAL DEPUTY DIRECTOR OF TOWN & COUNTRY PLANNING,
 SALEM REGION SALEM - 7.
 Approved: U.S. 29 of T&C.P. Act, 1971 and numbered as Map No. 485
 DDPS/SD/CP No. 192/05 vide Proc. in Rec.
 No. 8972003 DP1 Dated: 19.09.05.

ASSISTANT DIRECTOR OF TOWN AND COUNTRY PLANNING,
 DEPUTY DIRECTOR OF TOWN AND COUNTRY PLANNING,
 JOINT DIRECTOR OF TOWN AND COUNTRY PLANNING.

ADDITIONAL DIRECTOR OF TOWN AND COUNTRY PLANNING.

DIRECTOR OF TOWN AND COUNTRY PLANNING,
 CHENNAI.

DIRECTORATE OF TOWN AND COUNTRY PLANNING,
 GOVERNMENT OF TAMILNADU, CHENNAI.

SCHEDULE	DETAILS
I	COMPENSATION SCHEDULES Nos. 173 Nos. 1702, BLOCK NO.217'S NOT FOR BLDG. CT'S NOT FOR BLDG. NO.17'S Nos. 137018, 139711.
II PART I	ROADS TO BE FORMED BY THE L.P.A.
II PART II	ROADS TO BE FORMED BY THE OWNERS
IV	RESERVATION
VI	POOR CLASS AREA
VIII	COMMERCIAL AREA
IX	INDUSTRIAL AREA
X	MULTISTORIED BUILDING

WARD	DETAILS
WARD-C	BLOCK NO.8 : TS Nos. 403, 404, BLOCK NO.20 : TS Nos. 271, 23, 142, 34, 15, 16, 17, 2 WARD - D BLOCK NO.17'S Nos. 12, 3.
WARD-D	BLOCK NO.1 PART
WARD-D	BLOCK NO.7 PART
WARD-D	BLOCK NO.19 PART

