

RA THI NASAMY PURAM T.P. SCHEME

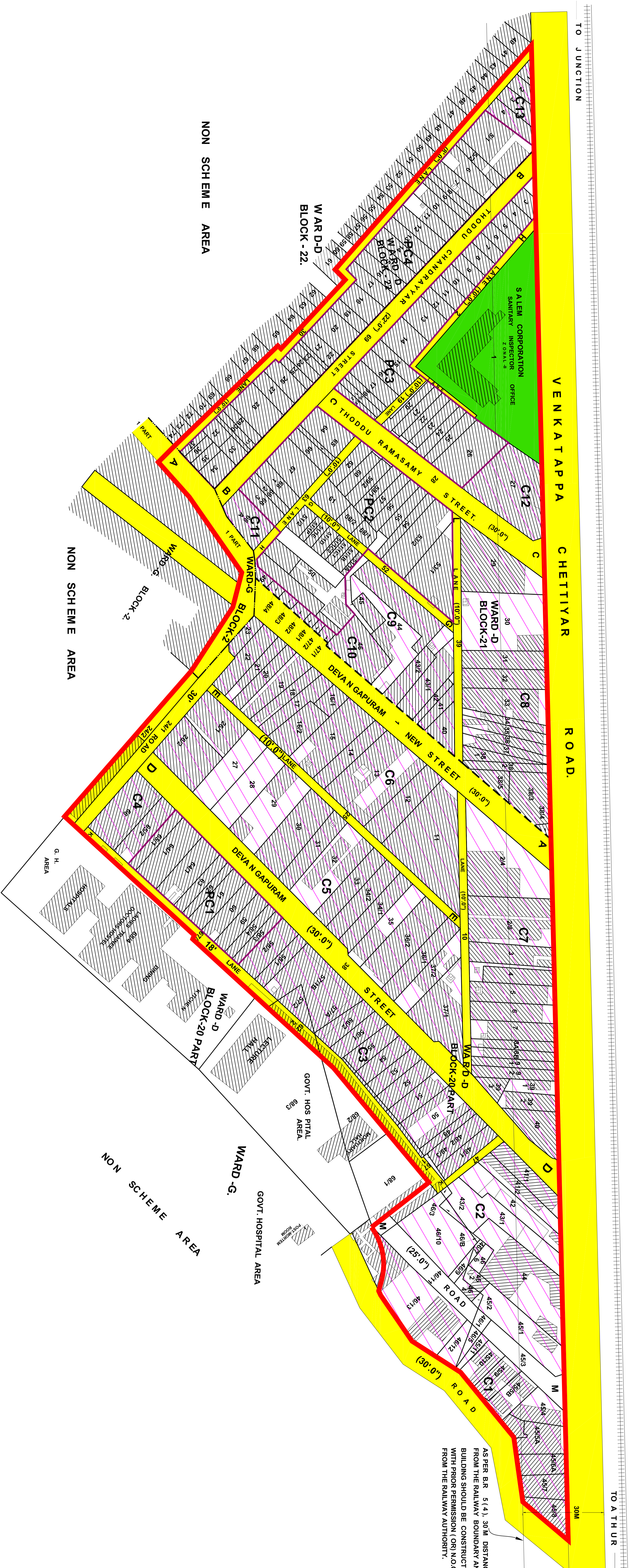

SAL EM CORPORATION  
DEVANGAPURAM EXTENSION(T.P.SCHEME) DETAILED  
DEVELOPMENT PLAN  
(REVIEW)

MAP No. 5

LEGEND

- DETAILED DEVELOPMENT PLAN BOUNDARY
- EXISTING ROADS, STREETS AND LANES
- PROPOSED ROADS, STREETS & LANES TO BE FORMED BY THE LOCAL BODY
- PROPOSED ROADS, STREETS & LANES TO BE FORMED BY THE OWNERS
- PROPOSED WIDENING OF EXISTING ROADS & STREETS TO BE FORMED BY THE LOCAL BODY
- PROPOSED WIDENING OF EXISTING ROADS & STREETS TO BE FORMED BY THE OWNERS
- RESERVED FOR RESIDENTIAL PURPOSES
- RESERVED FOR COMMERCIAL PURPOSES
- RESERVED FOR INDUSTRIAL PURPOSES
- RESERVED FOR PUBLIC & SEMI-PUBLIC PURPOSES
- RESERVED FOR EDUCATIONAL PURPOSES
- BUILDING LINE
- WARD BOUNDARY
- BLOCK BOUNDARY
- POOR CLASS AREA

**BUILDING LINE**  
 BELOW 30' (9.14 M) WIDE ROADS - 50' (15.24 M)  
 30' (9.14 M) ROADS AND BELOW 90' (27.43 M) ROADS - 10' (3.05 M)  
 90' (27.43 M) ROADS AND BELOW 80' (24.38 M) ROADS - 15' (4.57 M)  
 80' (24.38 M) ROADS AND ABOVE - 20' (6.10 M)  
 FOR NATIONAL HIGHWAYS & STATE HIGHWAYS - 25' (7.62 M)

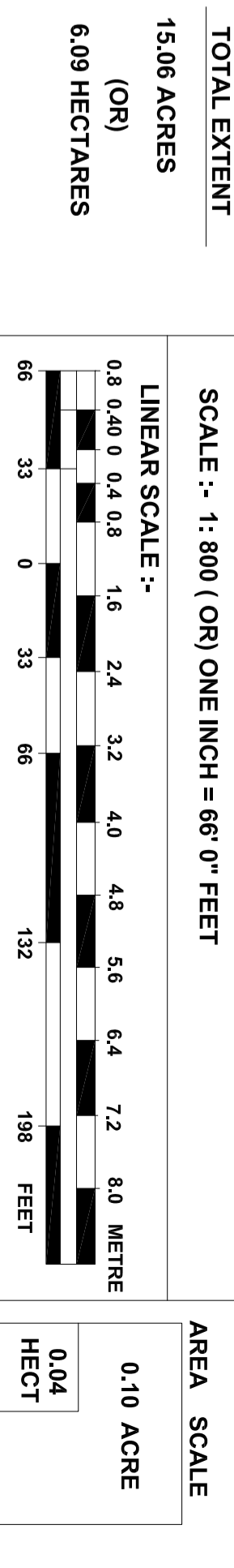

REGIONAL DEPUTY DIRECTOR OF TOWN AND COUNTRY PLANNING  
SALEM, 7.

Comprehensive variation u/s 33(1) of T & CP Act, 1971 and numbered as  
Map No.5, DDP(V)/DTC/P.No. 33/2005 wide proceedings  
In Roc No.1343 / 2000 DP1  
Dt.21-9-2005.

SCHEDULE	DETAILED	
I	COMPRISING S.F. Nos./T.S. Nos.	WARD-D, BLOCK-20 T.S. No. 1 TO 67, BLOCK-21 T.S. No. 1 TO 69, BLOCK-22 T.S. No. 1 TO 39, WARD-G, BLOCK-2 T.S. NO. 1PR.
III PART I	ROADS TO BE FORMED BY THE LPA	----- NIL -----
III PART II	ROADS TO FORMED BY THE OWNERS	----- NIL -----
IV	RESERVATION	WARD-D, BLOCK-21 T.S. NO.1
VII	POOR CLASS AREA	WARD-D, BLOCK-20 T.S. NOS. 80, 81/1A, 1B, 1C, 1D, 1E, 1F, 2, 3/1, 2, 3, 4 TO 57, 58, 59, 60 TO 63, 64/1, 2, 65/1, 66, 67, 68/1, 2, 3; BLOCK 21 T.S. NOS 3 TO 17, 18/1, 2, 20 TO 26, 28/2; BLOCK 22 T.S. NOS 51, 2, 6 TO 37
VIII	COMMERCIAL AREA	WARD-D, BLOCK-20 T.S. NOS 21, 2, 3 TO 7, 8A, 8B, 9/1, 2, 11 TO 15, 16/1, 2, 17 TO 23, 26/1, 2, 27 TO 33, 34/1, 2, 35, 36/1, 2, 37/1, 2, 38/1, 2, 3, 40, 41/1, 2, 42, 43/1, 2, 44, 45/1, 2, 45A, 58, 6 TO 11, 46/2 TO 10, 12, 13, 48/1, 2, 3; 49 TO 55, 56/1, 2, 57/1A, 1B, 2, 58/1, 2, 59/2, 66
IX	INDUSTRIAL AREA	----- NIL -----
X	MULTI-STORIED BUILDING	----- NIL -----

ASSISTANT DIRECTOR OF TOWN & COUNTRY PLANNING  
CHENNAI, 2

ADDITIONAL DIRECTOR OF TOWN AND COUNTRY PLANNING  
CHENNAI, 2

DIRECTOR OF TOWN AND COUNTRY PLANNING  
CHENNAI, 2