

**OFFICE OF DISTRICT MAGISTRATE, PATHANKOT**

**(Disaster Management Branch)**

Order No. 703

**ORDER**

It has come to the notice of the undersigned that there is one confirmed positive case of Covid-19 in Anandpur Rara/Kulian, Pathankot. In the light of Containment Plan guidelines issued by the Ministry of Health and Family Welfare, Govt of India, Para 6.4.1 **Containment Zone and Buffer Zone** are declared as under: -

**CONTAINMENT ZONE (PLAN ANNEXED) :**

The area coloured in pink starting from west corner "A" in front of Sunny Tent House, towards corner "B" Anandpur Kulian Chowk, then from corner "B" to "C" , then corner "C" to "D" near Shashi Halwai, then corner "D" to "E" adjoining Gali, then corner "E" to "F", then corner "F" to "A" is declared as Containment Zone and Indra colony Gali No. 1 would be single exit entry point for this zone.

**BUFFER ZONE (PLAN ANNEXED):**

Area coloured in green starting from point "1" adjoining Sunny Tent house Gali to point "2" Opposite Hanuman Mandir Gali, then from point "2" to point "3" near Holi Heart School Ganda Nala, then from point "3" to point "4" Gali Papu Lamberdar Wali, then from point "4" to "5" Gaushala Road (excluding the Containment Zone) is declared as Buffer zone/area.

The Geographical limit of Containment Zone and Buffer Zone may vary depending upon the contact listing report of Rapid Response Team headed by Additional Deputy Commissioner (G), Pathankot and Epidemiologist.

Enclosed: Annexed Map

  
(Gurpreet Singh Khaira) IAS  
District Magistrate  
Pathankot

Endorsement No. DRA(T)/ 704 - 14

Dated: 11/04/2020

Copy to:

1. Commissioner, Jalandhar Division, Jalandhar.
2. S.S.P, Pathankot.
3. ADC(G), Pathankot.
4. Commissioner, Municipal Corporation, Pathankot.
5. SDM, Pathankot/DharKalan.
6. Civil Surgeon, Pathankot
7. DRO, Pathankot
8. All Special Executive Magistrates
9. All members of Isolation Facility Management Committee.
10. DPRO, Pathankot.

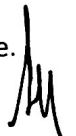

  
(Gurpreet Singh Khaira) IAS  
District Magistrate  
Pathankot

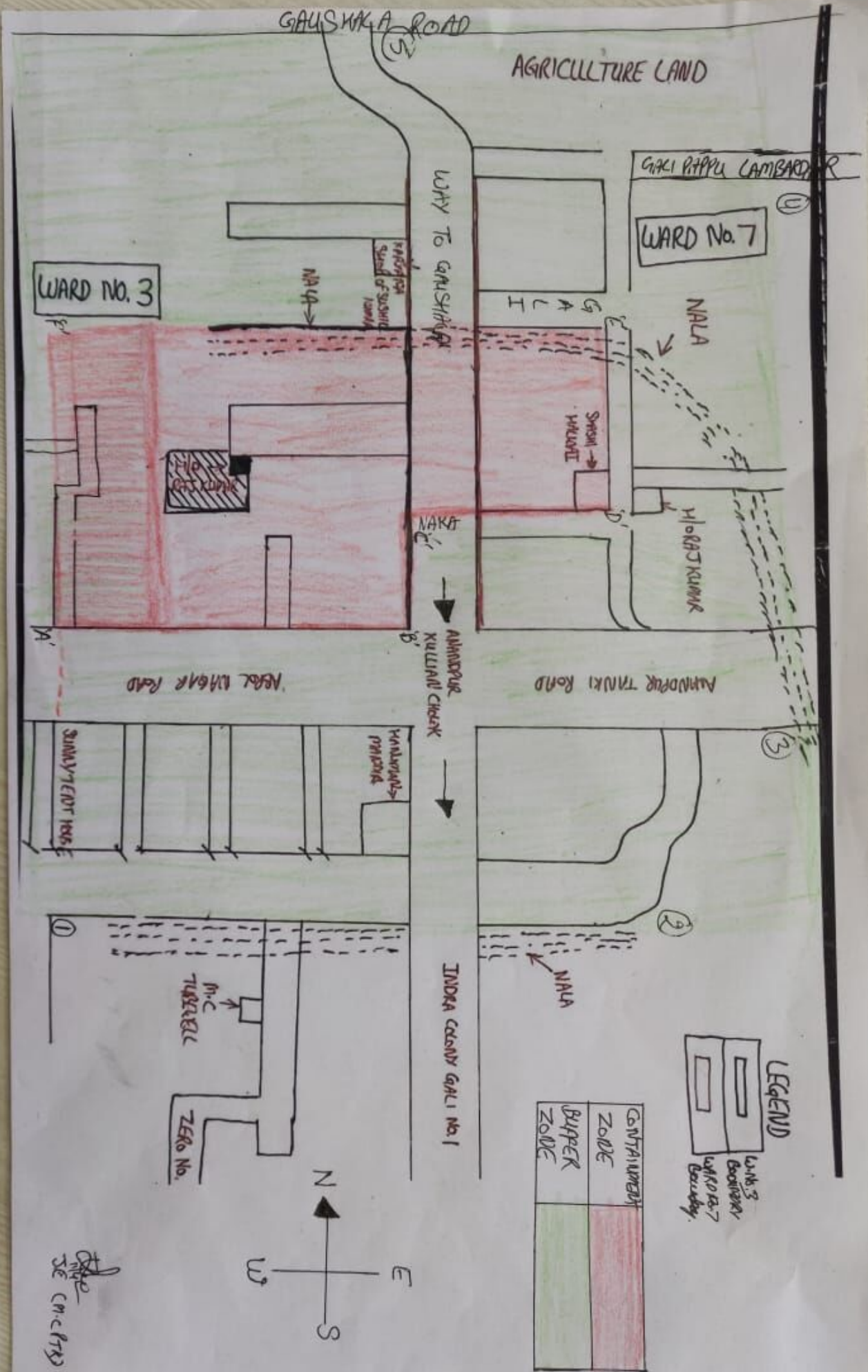

GAKI PAPPU LAMBARD R  
 WARD No. 7

WARD No. 3

GAUSKAKA ROAD

AGRICULTURE LAND

WHTY TO GAUSKAKA

GAUSKAKA

NANA

SMASHI  
 WHEARIT

MORAS KUNAK

NANA  
 AMNDUR  
 KULLIANI CHECK

NEAR WHEAR ROAD

AMNDUR TANUKI ROAD

SUNNY TENT HOUSE

WHEARIT  
 AMNDUR

INDRA CANTY GALI No. 1

NANA

M.C  
 TURKIBALL

ZERO No.

LEGEND  
 WARD No. 3  
 BOUNDARY  
 WARD No. 7  
 BOUNDARY

CANTAINMENT ZONDE	
BAPPER ZONDE	

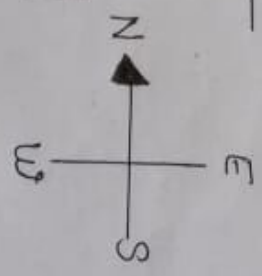

S.E (M.C.F.R.)