



बिहार सरकार  
जिला परिषद  
सिवान बिहार  
सीमित निविदा आमंत्रित करने की सूचना

उपविकास आयुक्त-सह-मुख्य कार्यपालक पदाधिकारी, सिवान द्वारा निम्नलिखित के लिए मुहरबंद निविदा आमंत्रित की गई है :-

NIT NO	Name of Work	QTY	Estimated	Earnest Money	Tender Cost (Non refundable)	Last date for submission of tender	Time for opening of tender
	Supplying and Installation of Modular Furniture for Chambers & Office area at Zila Parisad , Siwan, Bihar	As Per BOQ	23.00 Lacs	12000.00	1000.00	15-10-18	3.30 PM

ह0/-  
उपविकास आयुक्त-सह-  
मुख्य कार्यपालक पदाधिकारी,  
सिवान बिहार

ज्ञापक 272 /

दिनांक 26/09/2018 /



GOVERNMENT OF BIHAR

जिला परिषद

सिवान, बिहार

## TENDER DOCUMENT

SUPPLYING AND INSTALLATION OF MODULAR FURNITURE FOR CHAMBER & OFFICE AREA  
AT ZILA PARISHAD

# TECHNICAL BID DOCUMENT

## SECTION-1

(VOL-I)

### General Term & Conditions for Tender

**TWO-BID SEALED TENDERS ARE INVITED FROM BIDDER WHO SATISFY THE FOLLOWING PRE-QUALIFICATION CRITERIA FOR THE ABOVE-MENTIONED WORKS**

Tender will be opened in the presence of authorized representative of bidders, if they present themselves. Each of these instructions must be carefully read and followed strictly; failure in complying with any of these would render your offer for rejection.

1. The offer should be in sealed envelope and preferably sent by hand /Registered Post/ Speed post. Intending bidders are advised to post their offers well in time so as to reach us before bid due date and time. **The offer would be in two sealed envelopes comprising Technical bid including earnest money deposit and financial bid.** These should be sealed and superscribed as "Technical Bid for **SUPPLYING AND INSTALLATION OF OFFICE FURNITURE FOR CHAMBER & OFFICE AREA AT ZILA PARISHAD** and "Financial Bid for **SUPPLYING AND INSTALLATION OF OFFICE FURNITURE FOR CHAMBER & OFFICE AREA AT ZILA PARISHAD** "The two envelopes should be put in another envelope and sealed and sent to The DDC cum CEO , Zila Parishad , Siwan , Bihar , as indicated in the Para before.

**2. The Prequalifying or eligibility terms are given below:-**

- A) The Tenderer should have been a manufacturer/ Authorized Dealer or an authorized Agency from the principal of the brand being offered in tender.
- B). GST certificates.
- C). Bidder or their principle should have the registration in Government E market place.
- D). Principle or Bidder having a single / multiple work order for supplying and installation of modular furniture not less 50.00 Lacs within 1 Years from Bihar government /Zila Parishad / Nagar Nigam / Nagar Parishad / Bihar Government Board offices..

OR

Bidder should having a minimum experience in Past 5 years of supplying and installation of modular furniture work minimum of Rs 60.00 Lacs in any Bihar State Government offices.

- E. The total turnover of the bidders should be not less than Rs 1.00 crores in the last five financial years. The turnover should be enclosed in the technical bid.  
(2013-14+ 2014-15+2015-16+2016-2017+2017-2018=1.00 Crores)
- F. The bidder should have their offices in Bihar for the service purpose.
- G. All work should be completed with 30-45 Days from issue of work order. (Self declaration on letter head should be enclosed with technical bid)
3. Furnish self-declaration that bidder is not blacklisted in any State / Central governments work.
4. In case any change in the name of the company / address vis-a-vis what has been Indicated in the tender inquiry, bidders are requested to intimate such changes in advance Supported by relevant document failing which the offer may be treated as unsolicited and run the risk of being not opened.
5. The quoted price must be written in both figures and words in capital letters. Alteration if any should be made clearly by crossing the whole entered rate and last correction should be attested by the tenderer with their full signature and rubber stamp. In no case there should be overwriting and all tenders with such overwriting shall be liable for rejection, In case of any discrepancy between figures and words, the rates on words shall be considered for the purpose of evaluation.
6. The rates shall be for total amount payable by the dept. inclusive of all i.e. of GST, freight etc.
7. Offers should strictly be as per the specification / drawing as spelt out in the enquiry. No deviation shall be accepted ;( Deviations are likely to render the tender non-considerable. Bidders are advised not to deviate).
8. Tenderer should base his offer in the delivery schedule indicated in the enquiry. In case of any deviation, the tenderer should quote his realistic delivery; the same shall be specific and guaranteed. The delivery period shall commence from the date of mail / work order whichever is the first intimation of acceptance of vendor's offer. Final dates of delivery shall be the date of receipt of materials at Zila Parishad Siwan. The vendor shall take into account 7 days' notice to Dept. for deputing the authority. For delays beyond the Contractual delivery period, provisions of purchase conditions shall apply.
9. Department reserves the right to split / accept or reject any / all offer without assigning any reason thereof to increase / decrease the tendered quantity. The quoted rates, shall apply.
10. All Bidders should participate for all the tender items, part work cannot be acceptable. In case of part tender bidder can disqualify from tender.
- 11 Make / Brand with agency authorization letter of the offered are to be specified. Images or detailed descriptive or coloured pamphlets shall be enclosed with the price bid.
- 12.
- A. Payment will be made in running account system for continuous works. The bill will be submitted by the Contractor as per Zila Parishad , siwan. The Department is not bound to make payment for works considerably lower than warranted by the proportionate time. .
13. Dept. will consider Principle Company experience but bidders should submit Legal agreement between the Principle Company and Bidder.

14. The quoted rates must be firm till the complete execution of the contract and must be valid for a period of forty five days from the date of opening of tenders for placement of order.
15. In case of placement of an order, the tenderer should sign the Performa for terms & conditions and submit the same along with their offer in Duplicate.
16. Any manufacturing defects / poor workmanship / poor performance and in case any deficiencies are found during the guarantee/warranty period the same shall be repaired / rectified / replaced free of cost.
17. The list of customers from the agency/Principle company to who tendered had supplied the material in the past should be furnished along with the list should enclosed with the tender.
18. Bidders may note that the due date and time of opening of tenders will be strictly adhered to and accordingly if they wish to be present themselves at the tender opening, they should bring necessary authorization letter from the company. However due to declaration of unexpected holidays or any unforeseen circumstance if the tenders are not opened on the due date, the same will be opened on the next working day.
19. Bidders should use the approved brands only and also after the successful installation. Company/Bidders should submit company warranty certificates of the supplied items.
20. No claim for idle labour under any circumstance will be entertained by the department.
21. The awarded agency or his authorized person shall always be present at site while the work is in progress and also at the time of final measurement.
22. The work will be carried out in protected area. Hence all the rules and regulations of the department which are enforced from time to time shall have to be followed.
23. Before submission of the tender, the tenderers shall acquaint themselves with the site conditions so that they may get an idea of the working conditions and incorporate all exigencies and cost effect in the quoted rates.
24. The contractor/Bidder will have to co-ordinate their work with other agencies working in the area and no claim for delay in work due to idle labour on any account will be entertained.
25. Tenderer must deposit the Earnest Money as mentioned in the tender notice in the shape of Bank Draft. Drawn in the favour of CEO Zila Parishad Siwan.
26. Permanent address of the bidder for correspondence should be furnished in tender documents otherwise the tender will not be considered.
27. Tenderer should satisfy that the statements as required along with the tender documents are correct and complete in every respect. Any inaccuracy detected later shall vitiate the contract and make the contractor/ bidder liable to be proceeded against.
- 28.. The tendering authority has reserves the right not to accept the lowest or any quotation and has also the right for acceptance of the whole or any part of the tender or portion of the item offered, also reserves the right to cancel the tender at its own discretion.

## SPECIAL CONDITION OF TENDER

*(To be attached with Technical & Commercial Part)*

1. **PRICE** : Tender items rates should not be more than the GEM portal approved Rates , If items are registered in GEM portal.
2. **IDLE CHARGES.**  
No charges for idle man, machine, plant and equipment will be allowed to the agency for some reason or the other beyond the control of the department.
3. **TAXES**  
The rates should be quoted including all taxes on all commodities. GST is levied by Govt. of BIHAR shall be paid by the bidder (If applicable).
4. **FREE MAINTENANCE PERIOD:-**  
Maintenance period will be counted from the date of completion of work for 12 months.
5. **EXTRA WORK**  
Any extra work done by the Bidder/Contractor will be paid as per schedule/tender approved rates. Before taking the work of extra item, it get must be approved by the competent authority to avoid subsequent dispute and delay in decision.
6. **PENALTY / LIQUIDATED DAMAGE.**  
For any delay in completion of work liquidated damages will be charged as per relevant clause will be applicable after the stipulated time frame 0.5 % per month on the balance work.
7. **VARIATION IN QUANTITIES OF WORK.**  
The quantity indicated in the Bill of quantity for items of work may increase or decrease.
8. **DEFECT LIABILITY PERIOD**  
Bidder should submit the purchasing Material guarantee/warrantee certificates (issue by the manufacturer should submit to Dept. Defects liability period (DLP) of 12 months commence from issue of Completion Certificate by Dept.
9. **DESCRIPTION OF RAW MATERIALS**  
The bidder shall submit a material detail i.e. Make/Brand which was using in the supply Items/Products.
10. **The Tenders As Submitted will Consist Of The Following:**
  - i) Invitation to Tender (ITT) and Commercial Terms & Conditions duly signed on each page as a token of acceptance of all terms and conditions mentioned therein.
  - ii) GST/ PAN Xerox copy.
  - iii) Copy of supporting document as required under Eligibility /Qualifying Criteria.
  - iv) In the financial bid, enclose the duly signed rates of the tender items in prescribed Performa as annexure herein below.

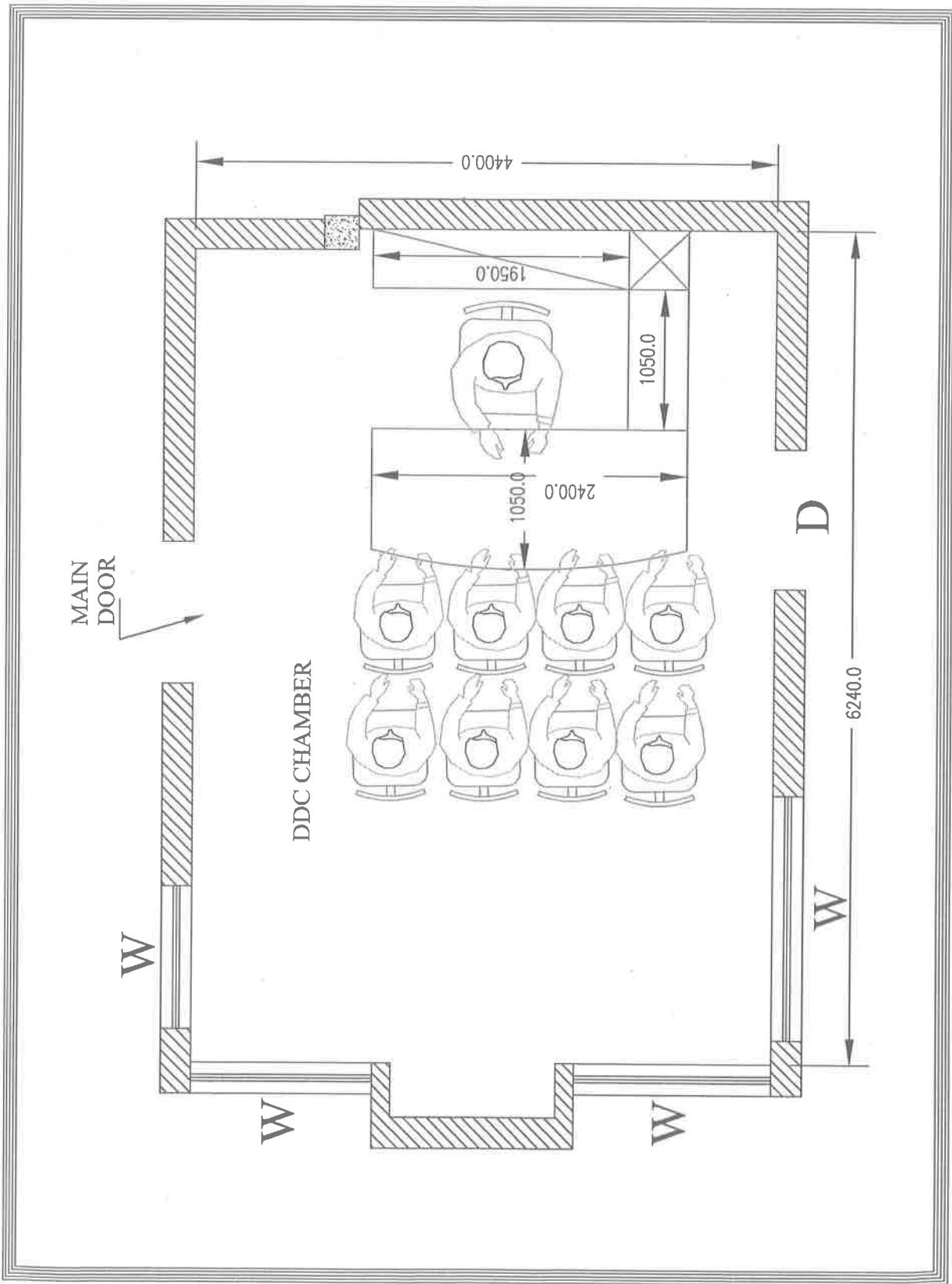

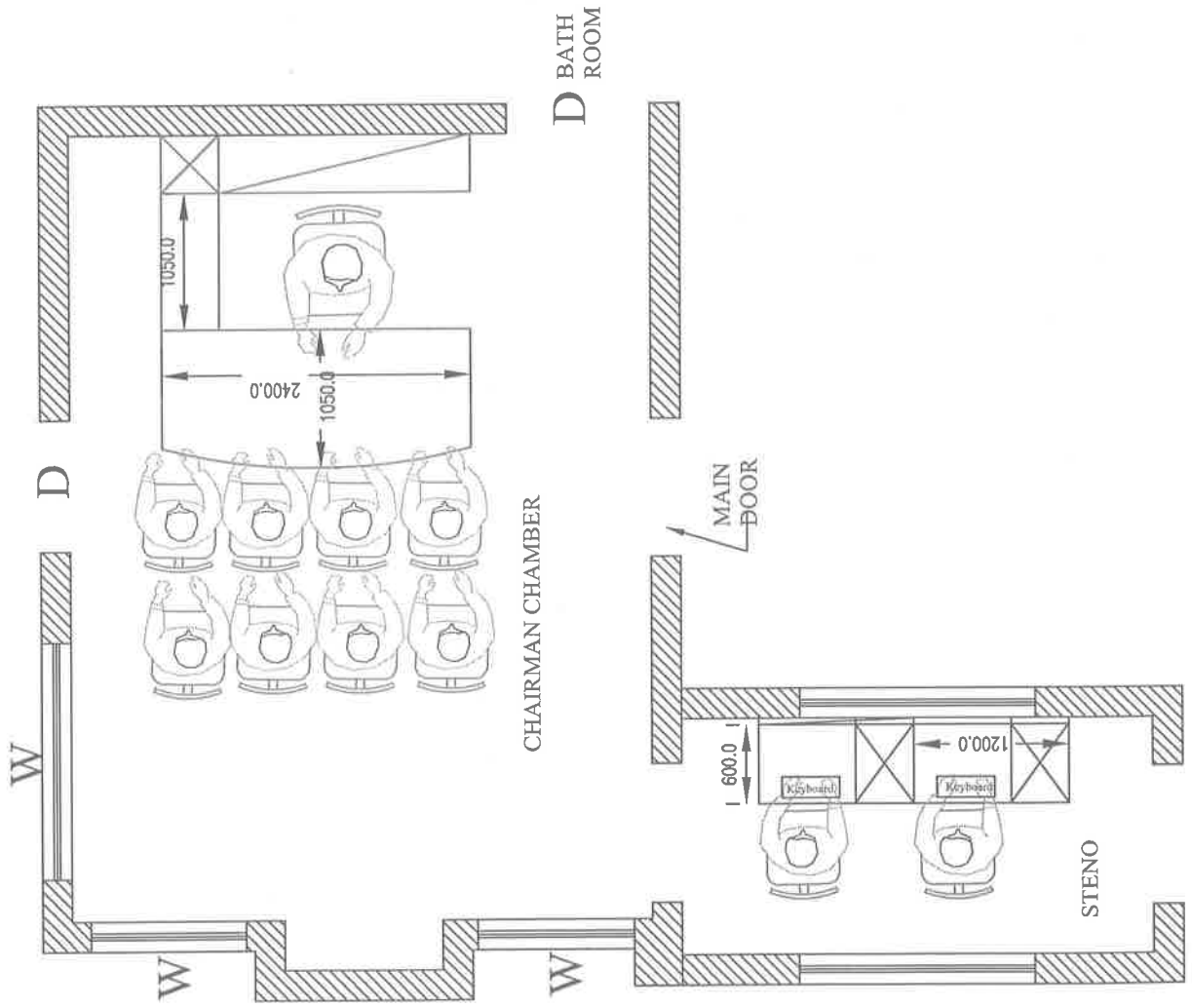

W

D

1050.0

2400.0

1050.0

CHAIRMAN CHAMBER

D BATH ROOM

MAIN DOOR

600.0

1200.0

STENO

W

W

W



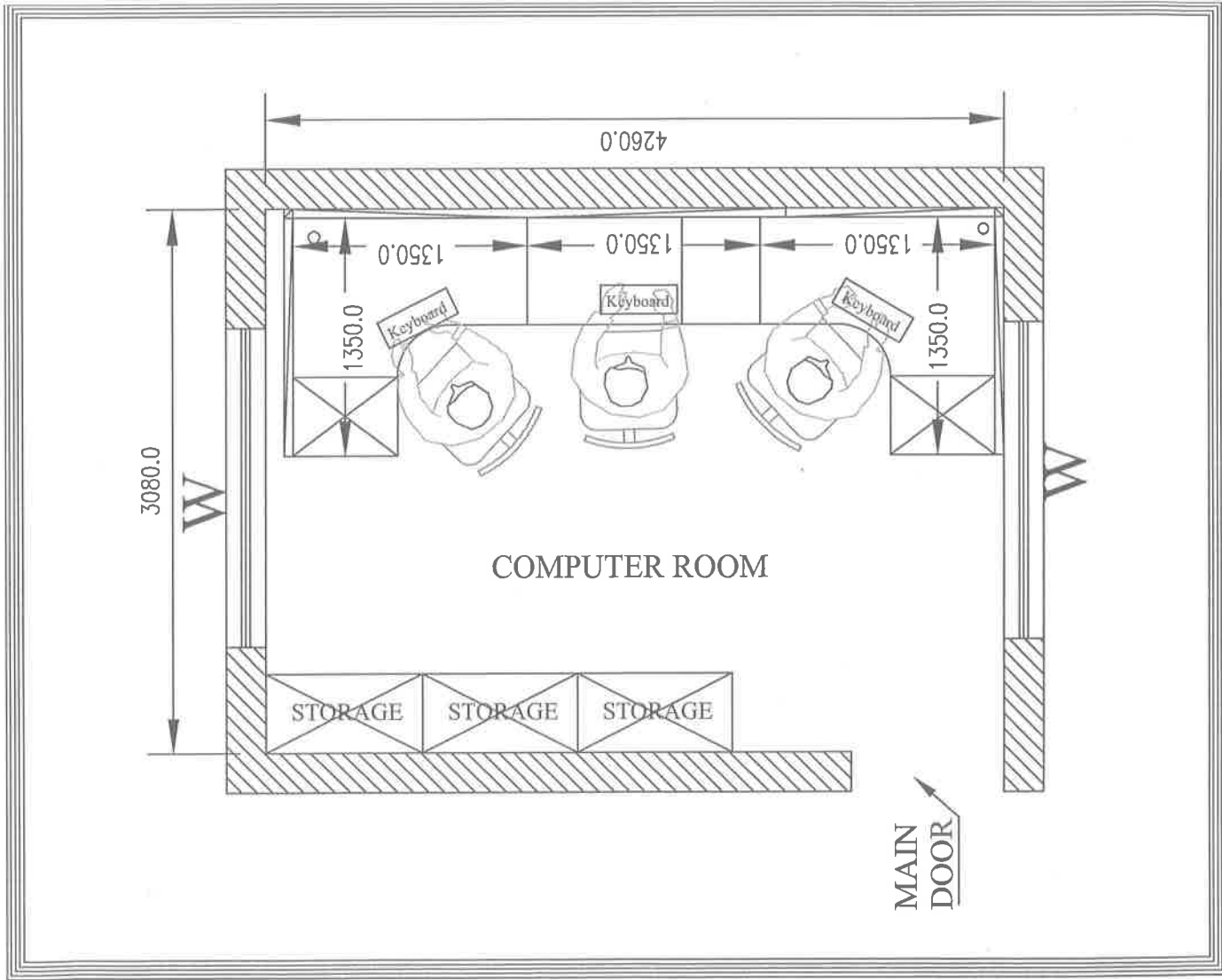

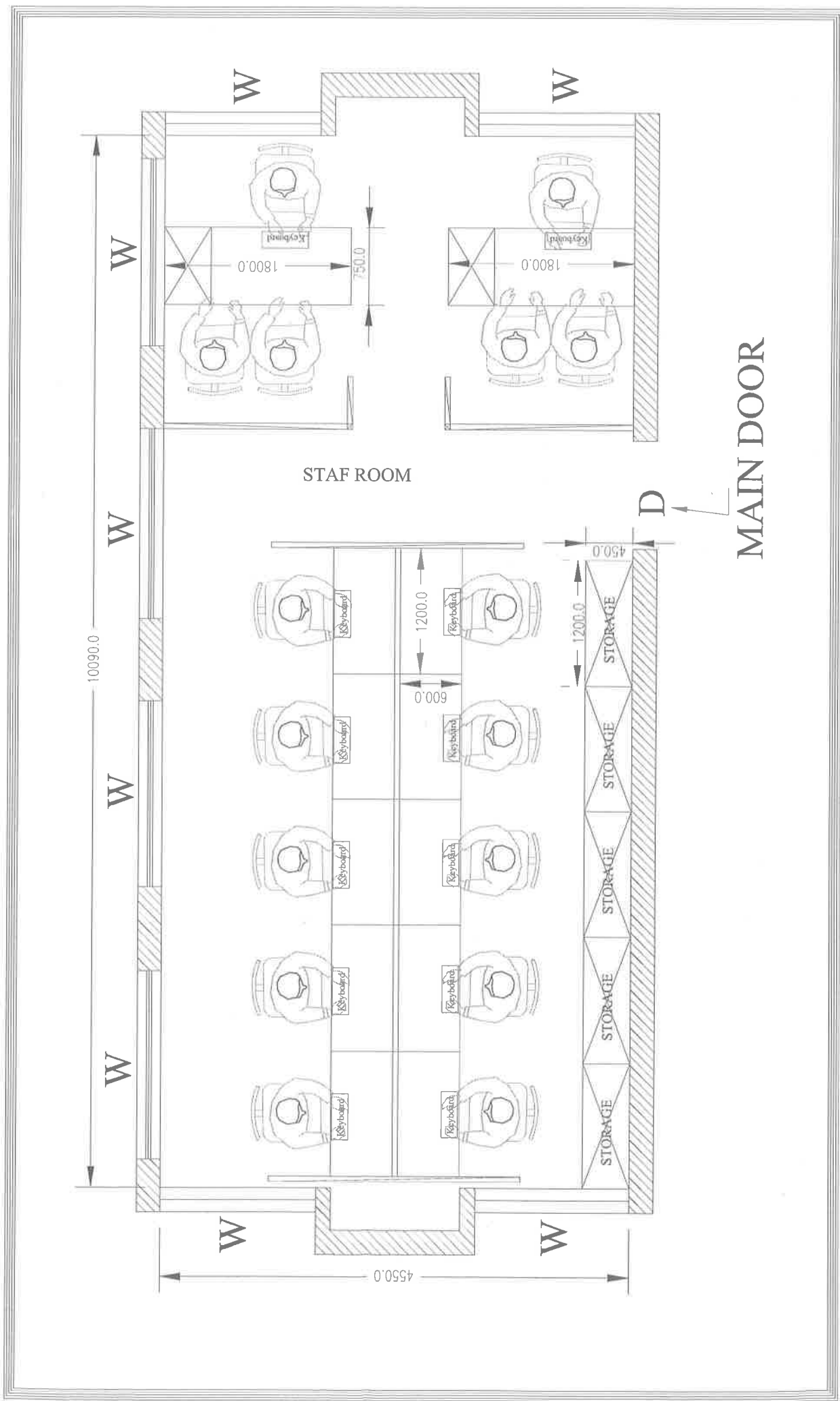

	A	B	C	D	E	F
1		<b>BOQ OF OFFICE OF DDC &amp; CHAIRMAN FURNITURE WORKS FOR ZILA PARISAD , SIWAN, BIHAR</b>				
2	<b>Sl. No.</b>	<b>PARTICULARS</b>	<b>UNIT</b>	<b>QTY</b>	<b>RATE</b>	<b>AMOUNT</b>
3	<b>1</b>	<b>CHAMBER TABLE FOR DDC CUM CEO &amp; CHAIRMAN ROOM As per layout.</b>				
4		This table would be a Free standing tables of size (W 1800 X D 750X H 750) made of MDF board table top of size 30-35 mm thk MDF with PLT modesty panel and legs, there would be top supported with ss or black finish studs below the work top ath 25 mm thk legs . This table,side unit 900 x 450 x 750 mm . Matching to the model SKN TM 0012 OR TM 0015 District Engg.Company MAKE only GODREJ / WIPRO/ SKN / FEATHERLITE /FINEX /INTEX or those company who are the vendor of <b>GOVERNMENT E MARKET PLUS</b> . MAKE only GODREJ / WIPRO/ SKN / FEATHERLITE /FINEX /INTEX) Table as per layout.	No	2		
5	<b>2</b>	<b>CHAMBER TABLE BACK UNIT</b>				
6		BACK STORAGE--PROVIDING AND FIXING OF MODULAR STORAGE IN MDF BOARD, STORAGE TOP SHALL BE OF 25MM POST FORMED, U/S IN 18MM MDF AND BACK IN 9MM PRELAM MDF BOARD, ALL THE EXPOSED EDGES SHALL BE PASTED WITH PVC EDGING TO BE PASTED WITH HOT MELT GLUE, STORAGE TO BE INSTALLED WITH MINIFIX FITTING. STORAGE LOCK, HINGES ETC. SHALL BE OF HETTICH/EBCO MAKE Sizes CONECTING TOP SIZE:- 1350 + 450 X 450 X 750 as per design provided by District Engg.Company MAKE only GODREJ / WIPRO/ SKN / FEATHERLITE /FINEX /INTEX or those company who are the vendor of <b>GOVERNMENT E MARKET PLUS</b> . MAKE only GODREJ / WIPRO/ SKN / FEATHERLITE /FINEX /INTEX) Table as per layout and model SKN CABINET 006 .	No	2		
7	<b>3</b>	<b>CHAIRS FOR DDC CUM CEO &amp; CHAIRMAN As per layout.</b>				
8		Providing ergonomically, comfortable and aesthetically design high back chairs.The seat and back made of hot pressed twin wooden ply 12mm+6mm thick uholstered with foam denisty 40 kg/m3 in seat and foam denisty 32 kg/m3 in back and leatherite tapestry.The revolving in 360' degree mechanism will be torsion bar type and arm rests are made of polyproplene chrome finish.Base is made of matel chrome finish with nylon five star with superior Nylon-6/Ultramid -56 twin wheel castors having self lubricating properties for friction free movement tested on BIFMA Standard .The mechanism is torsion bar with single point locking. The seat height adustment with bifma standard class 3 gas lift. Seat size shall be-21"(Depth),22"(width) and back height from seat -28.5". overall height -46" from floor..Matcing to Images .(Company MAKE only GODREJ / WIPRO/ SKN / FEATHERLITE /FINEX /INTEX)	Nos	2		
9	<b>4</b>	<b>VISITOR CHAIRS</b>				
10		Providing & Fixing of ergonomical, comfortable and aesthetically design visitor chair. The seat size shall be 480mm (W) x 500mm (D) and the back height shall be 540mm . The seat shall be made of hot pressed moulded ply(15mm thick) and Urethane foam upholstered (Foam density 40kg/m3) with Leatherette tapestry. The back frame shall be made up of CRC pipe dia.19mm X1.6mm thick) and covered with net and Urethane foam upholstered (Foam density 32kg/m3) with Leatherette tapestry,outer frame of back CRC pipe(25mm X 10mm X 1.6mm) and chrome plated which joint seat & back together. The armrests are made of CRC pipe (40mm X 10mm X 1.6mm) and covered with PU arm. There are PPCP shoes are used in bottom of frame for avoid skretches from floor.Matcing to model .(Company MAKE only GODREJ / WIPRO/ SKN / FEATHERLITE /FINEX /INTEX)	Nos	20		
11	<b>5</b>	<b>CHAIRMAN room Linear Cluster</b>				
12		Providing and Installation of Modular Partition having min. 52mm Thick slab based partition systems having a min. height of 1200mm (Where ever required soft board and white board to be included that as per instruction of Architect).These must be made from minimum 25mm pre-laminated particle board having their front working edge lipped with 2.0mm thick PVC edging. All other edges will be lipped with 0.8mm thick PVC edging.The worksurfaces will be mounted on panels by means of suitable cantilever brackets made from minimum 16 gauge CRCA steel duly powder coated.All worksurfaces shall conform to the following sections of ANSI / BIFMA X5.5-2008 – Tests for Desks & Table Products Work station carry Mobile pedestral, key board tray & CPU one person Curvilinear Work Surface with Modular Partition of Size 1200 Wx 600Dx 1200mmH and carry one pedestal and KBT and CPU as per above specs .(Company MAKE only GODREJ / WIPRO/ SKN / FEATHERLITE /FINEX /INTEX)	Nos	2		
13	<b>6</b>	<b>Low Back Chairs</b>				

A	B	C	D	E	F
14	Providing low back chair , seat is made of 12mm hot pressed ply wood with pu foam density 45kg/m3 and fabric tapestry &back made of Polypropylene with PU foam density is 35 kg/m3 , pp arm rest , gas lift BIFMA 3 standard telescopic gas lift cover , Nylon base 30% glass filled with twin wheel castor and Push back mechanism. The HR plate size 60mm X 6mm with Ribs powder coated and joint with back and mechanism. nylon base load capacity- 1250kg. seat size 18" (w) x 18" (d) , back hight 23" and Overall height -35.5" .(Company MAKE only GODREJ / WIPRO/ SKN / FEATHERLITE /FINEX /INTEX)	Nos	2		
<b>BOQ OF FURNITURE WORKS FOR DISTRICT ENGG. CHAMBER ZILA PARISAD, SIWAN, BIHAR</b>					
15					
16	<b>Sl. No.</b>	<b>UNIT</b>	<b>QTY</b>	<b>RATE</b>	<b>AMOUNT</b>
17	<b>1 CHAMBER TABLE OF DISTRICT ENGG + 1</b>				
18	This table would be a Free standing tables of size (W 1650 X D 1500 X H 750) made of PLT board table top of size 25 mm thk PLT with PLT modesty panel and legs, This table,side unit 900 x 450 x 750 mm . Matching to the model SKN TM 0018 District Engg.Company MAKE only GODREJ / WIPRO/ SKN / FEATHERLITE /FINEX /INTEX or those company who are the vendor of <b>GOVERNMENT E MARKET PLUS</b> . MAKE only GODREJ / WIPRO/ SKN / FEATHERLITE /FINEX /INTEX) as per layout.	No	2		
19	<b>2 CHAIRS FOR DISTRICT ENGG + 1</b>				
20	Providing and fixing a medium back chair.The back is made of hot pressed 12+6 mm thick wooden twin ply upholstered with PU foam denisty 32 kg/m3 and Fabric tapestry.And seat is made of hot pressed 15mm thick wooden ply upholstered with PU foam denisty 40+/-2 kg/m3 and fabric tapestry.The mechanism revolving in 360' degree will be Synchro knee type and arm rest are made of adjustable polypropylene & top arm made of PU padding.Seat will be adjustable height 65mm by Gas lifter work in BIFMA standard class 3.Pedelstal is made of injection moulded black nylon fitted with 5 nos. twin wheels castors which are made of moulded black nylon in dia 65+/-0.5cm and the pitch centre dia shall be 75+/-1cm (with castors).Seat size shall be- 520mm (W) x 485mm (D) and back size shall be 510mm (H) from seat & overall height : 970 mm. Matcing to model .(Company MAKE only GODREJ / WIPRO/ SKN / FEATHERLITE /FINEX /INTEX)	Nos	2		
21	<b>3 VISITOR CHAIRS</b>				
22	Providing & Fixing ergonomically, comfortable and aesthetically design visitor chair. Push able back is made of polypropylene inner and outer cell and PU foam density 32+/-2 kg/m3 upholstered with fabric tapestry. The seat is made of 12mm thick wooden ply & PU foam density 40+/-2 kg/m3 upholster with fabric tapestry. Seat and back joint by HRC sheet size 40 x 9 mm cover with PP below. The armrests are made of injection moulded polypropylene. The seat base stand is made of Powder coated CRCA metal dia 25.46x2mmthick and there are PVC shoes are also available in the bottom of frame. Seat size-18.5"(W)17"(D) Back size-17"(H) from seat and overall height from floor -33.5". The base stand quality meet to BIFMA standard.I .(Company MAKE only GODREJ / WIPRO/ SKN / FEATHERLITE /FINEX /INTEX)	Nos	10		
23	<b>4 Linear Cluster for operator</b>				
24	Providing and Installation of Modular Partition having min. 52mm Thick slab based partition systems having a min. height of 1200mm (Where ever required soft board and white board to be included that as per instruction of Architect).These must be made from minimum 25mm pre-laminated particle board having their front working edge lipped with 2.0mm thick PVC edging. All other edges will be lipped with 0.8mm thick PVC edging.The worksurfaces will be mounted on panels by means of suitable cantilever brackets made from minimum 16 gauge CRCA steel duly powder coated.All worksurfaces shall conform to the following sections of ANSI / BIFMA X5.5-2008 – Tests for Desks & Table Products Work station carry Mobile pedestral, key board tray & CPU one person Curvilinear Work Surface with Modular Partition of Size 1200 Wx 600Dx 1200mmH and carry one pedestal and KBT and CPU as per above specs .(Company MAKE only GODREJ / WIPRO/ SKN / FEATHERLITE /FINEX /INTEX)	Nos	1		
25	<b>6 Low Back Chairs</b>				
26	Providing low back chair , seat is made of 12mm hot pressed ply wood with pu foam density 45kg/m3 and fabric tapestry &back made of Polypropylene with PU foam density is 35 kg/m3 , pp arm rest , gas lift BIFMA 3 standard telescopic gas lift cover , Nylon base 30% glass filled with twin wheel castor and Push back mechanism. The HR plate size 60mm X 6mm with Ribs powder coated and joint with back and mechanism. nylon base load capacity- 1250kg. seat size 18" (w) x 18" (d) , back hight 23" and Overall height -35.5" .(Company MAKE only GODREJ / WIPRO/ SKN / FEATHERLITE /FINEX /INTEX)	Nos	1		

	A	B	C	D	E	F
27	<b>BOQ OF FURNITURE WORKS FOR STAFF ROOM ZILA PARISAD, SIWAN, BIHAR</b>					
28	<b>Sl. No.</b>	<b>PARTICULARS</b>	<b>UNIT</b>	<b>QTY</b>	<b>RATE</b>	<b>AMOUNT</b>
29	<b>1</b>	<b>CHAMBER TABLE For STAFF ROOM</b>				
30		This table would be a Free standing tables of size (W 1800 X D 750X H 750) made of Postformed table top of size 25 mm thk PLTwith PLT modesty panel and legs,This table carry pedestral unit 450 x 500 x 695 mm . Matching to the model SKN TM 0012 OR TM 0015 District Engg.Company MAKE only GODREJ / WIPRO/ SKN / FEATHERLITE /FINEX /INTEX or those company who are the vendor of <b>GOVERNMENT E MARKET PLUS</b> . MAKE only GODREJ / WIPRO/ SKN / FEATHERLITE /FINEX /INTEX). Table as per layout.	No	2		
31	<b>2</b>	<b>CHAIRS FOR STAFF</b>				
32		Providing and fixing a low back chair.The back is made of hot pressed 12+6 mm thick wooden twin ply upholstered with PU foam denisty 32 kg/m3 and Fabric tapestry.And seat is made of hot pressed 15mm thick wooden ply upholstered with PU foam denisty 40+/-2 kg/m3 and fabric tapestry.The mechanism revolving in 360' degree will be Synchro knee type and arm rest are made of adjustable polypropylene & top arm made of PU padding.Seat will be adjustable height 65mm by Gas lifter work in BIFMA standard class 3.Pedelstal is made of injection moulded black nylon fitted with 5 nos. twin wheels castors which are made of moulded black nylon in dia 65+/-0.5cm and the pitch centre dia shall be 75+/-1cm (with castors).Seat size shall be- 520mm (W) x 485mm (D) and back size shall be 510mm (H) from seat & overall height : 970 mm. Matcing to model .(Company MAKE only GODREJ / WIPRO/ SKN / FEATHERLITE /FINEX /INTEX)	Nos	2		
33	<b>3</b>	<b>VISITOR CHAIRS</b>				
34		Providing & Fixing of ergonomical, comfortable and aesthetically design visitor chair. The seat size shall be 480mm (W) x 500mm (D) and the back height shall be 540mm . The seat shall be made of hot pressed moulded ply(15mm thick) and Urethane foam upholstered (Foam density 40kg/m3) with Leatherette tapestry. The back frame shall be made up of CRC pipe dia.19mm X1.6mm thick) and covered with net and Urethane foam upholstered (Foam density 32kg/m3) with Leatherette tapestry,outer frame of back CRC pipe(25mm X 10mm X 1.6mm) and chrome plated which joint seat & back together. The armrests are made of CRC pipe (40mm X 10mm X 1.6mm) and covered with PU arm. There are PPCP shoes are used in bottom of frame for avoid skretches from floor.Matcing to model .(Company MAKE only GODREJ / WIPRO/ SKN / FEATHERLITE /FINEX /INTEX)	Nos	4		
35	<b>4</b>	<b>Linear &amp; Curvilinear Cluster for office area</b>				
36	<b>A</b>	Providing and Installation of Modular Partition having min. 52mm Thick slab based partition systems having a min. height of 1200mm (Where ever required soft board and white board to be included that as per instruction of Architect).These must be made from minimum 25mm pre-laminated particle board having their front working edge lipped with 2.0mm thick PVC edging. All other edges will be lipped with 0.8mm thick PVC edging.The worksurfaces will be mounted on panels by means of suitable cantilever brackets made from minimum 16 gauge CRCA steel duly powder coated.All worksurfaces shall conform to the following sections of ANSI / BIFMA X5.5-2008 – Tests for Desks & Table Products Work station carry Mobile pedestral, key board tray & CPU one person Curvilinear Work Surface with Modular Partition of Size 1200 Wx1200 Dx 1200mmH and carry one pedestal and KBT and CPU as per above spect. .(Company MAKE only GODREJ / WIPRO/ SKN / FEATHERLITE /FINEX /INTEX)	Nos	4		
37	<b>B</b>	Providing and Installation of Modular Partition having min. 52mm Thick slab based partition systems having a min. height of 1200mm (Where ever required soft board and white board to be included that as per instruction of Architect).These must be made from minimum 25mm pre-laminated particle board having their front working edge lipped with 2.0mm thick PVC edging. All other edges will be lipped with 0.8mm thick PVC edging.The worksurfaces will be mounted on panels by means of suitable cantilever brackets made from minimum 16 gauge CRCA steel duly powder coated.All worksurfaces shall conform to the following sections of ANSI / BIFMA X5.5-2008 – Tests for Desks & Table Products Work station carry Mobile pedestral, key board tray & CPU one person Curvilinear Work Surface with Modular Partition of Size 1200 Wx 600Dx 1200mmH and carry one pedestal and KBT and CPU as per above spect. .(Company MAKE only GODREJ / WIPRO/ SKN / FEATHERLITE /FINEX /INTEX)	Nos	6		

	A	B	C	D	E	F
38	C	Providing and fixing low back chairs seat is made of 12mm hot pressed ply wood with pu foam density 45kg/m3 and fabric tapestry & back made of Polypropylene with PU foam density is 35 kg/m3 , pp arm rest , gas lift BIFMA 3 standard telescopic gas lift cover , Nylon base 30% glass filled with twin wheel castor and Push back mechanism. The HR plate size 60mm X 6mm with Ribs powder coated and joint with back and mechanism. nylon base load capacity- 1250kg. seat size 18" (w) x 18" (d) , back hight 23" and Overall height -35.5" .(Company MAKE only GODREJ / WIPRO/ SKN / FEATHERLITE /FINEX /INTEX)	Nos	10		
39	D	LOW HEIGHT STORAGE 1500X450X1200H--PROVIDING AND FIXING OF MODULAR STORAGE IN PLT BOARD, STORAGE TOP SHALL BE OF 25MM POST FORMED, U/S IN 18MM AND BACK IN 9MM PRELAM MDF BOARD, ALL THE EXPOSED EDGES SHALL BE PASTED WITH PVC EDGING TO BE PASTED WITH HOT MELT GLUE, STORAGE TO BE INSTALLED WITH MINIFIX FITTING. STORAGE LOCK, HINGES ETC. SHALL BE OF HETTICH/EBCO MAKE (Company MAKE only GODREJ / WIPRO/ SKN / FEATHERLITE /FINEX /INTEX)	Nos	10		
40	<b>BOQ OF FURNITURE WORKS FOR COMPUTER OPERATOR ZILA PARISAD, SIWAN, BIHAR</b>					
41	Sl. No.	PARTICULARS	UNIT	QTY	RATE	AMOUNT
42	1	<b>Linear Cluster for Computer Operator</b>				
43		Providing and Installation of Modular Partition having min. 52mm Thick slab based partition systems having a min. height of 1200mm (Where ever required soft board and white board to be included that as per instruction of Engg). These must be made from minimum 25mm pre-laminated particle board having their front working edge lipped with 2.0mm thick PVC edging. All other edges will be lipped with 0.8mm thick PVC edging. The work surfaces will be mounted on panels by means of suitable cantilever brackets made from minimum 16 gauge CRCA steel duly powder coated. All work surfaces shall conform to the following sections of ANSI / BIFMA X5.5-2008 – Tests for Desks & Table Products Work station carry Mobile pedestral, key board tray & CPU one person Curvilinear Work Surface with Modular Partition of Size 1050 Wx600Dx 1200mmH and carry one low ht. pedestral 555 x 450 x 380 mm and KBT and CPU as per above specs. .(Company MAKE only GODREJ / WIPRO/ SKN / FEATHERLITE /FINEX /INTEX)	Nos	3		
44	2	Providing and fixing a low back chairs with sizes of seat is made of 12mm hot pressed ply wood with pu foam density 45kg/m3 and fabric tapestry & back made of Polypropylene with PU foam density is 35 kg/m3 , pp arm rest , gas lift BIFMA 3 standard telescopic gas lift cover , Nylon base 30% glass filled with twin wheel castor and Push back mechanism. The HR plate size 60mm X 6mm with Ribs powder coated and joint with back and mechanism. nylon base load capacity- 1250kg. seat size 18" (w) x 18" (d) , back hight 23" and Overall height -35.5" .(Company MAKE only GODREJ / WIPRO/ SKN / FEATHERLITE /FINEX /INTEX)	Nos	3		
45	3	<b>LOW HEIGHT STORAGE 1200L X450 D X1200H--PROVIDING AND FIXING OF MODULAR STORAGE IN PLT BOARD, STORAGE TOP SHALL BE OF 25MM POST FORMED, U/S IN 18MM AND BACK IN 9MM PRELAM MDF BOARD, ALL THE EXPOSED EDGES SHALL BE PASTED WITH PVC EDGING TO BE PASTED WITH HOT MELT GLUE, STORAGE TO BE INSTALLED WITH MINIFIX FITTING. STORAGE LOCK, HINGES ETC. SHALL BE OF HETTICH/EBCO MAKE (Company MAKE only GODREJ / WIPRO/ SKN / FEATHERLITE /FINEX /INTEX)</b>	Nos	2		
46	<b>BOQ OF FURNITURE WORKS FOR Jr. Engg. &amp; others staff AT PARISAD, SIWAN, BIHAR</b>					
47	Sl. No.	PARTICULARS	UNIT	QTY	RATE	AMOUNT
48	1	<b>LARGE TABLE</b>				
49		Table size 1665W x 900Dx750H (mm) made up of 18mm prelaminated board duly sealed with 2 mm PVC beading on all sides. Understructure made up of C frame with CRCAMS sheet of 0.9 mm thick, tubular frame of MS ERW round tube of dia 25.4mm x 1.2mm thick, Modesty panel made up of 1mm thick CRCAMS sheet. Storage made up of three drawer unjt on right and two drawer system on left side of the table with 0.5mm thick CRCAMS sheet of overall size 355.5 W x 5S9D x 433.5H.(Company MAKE only GODREJ / WIPRO/ SKN / FEATHERLITE /FINEX /INTEX)	Nos	1		

	A	B	C	D	E	F
50	<b>2</b>	<b>MEDIUM TABLE</b>				
51		Table size 1200W x 600 Dx750H (mm) made up of 18mm prelaminated board duly sealed with 2 mm PVC beading on all sides. Understructure made up of C frame with CRCAMS sheet of 0.9 mm thick, tublar frame of MS ERW round tube of dia 25.4mm x 1.2mm thick, Modesty panel made up of 1mm thick CRCAMS sheet. Storage made up of two drawer unit one side of the table with 0.5mm thick CRCAMS sheet of overall size 355.5 W x 5S9D x 433.5H	Nos	1		
52	<b>3</b>	<b>SMALL TABLE</b>				
53		Table size 1200W x 600 Dx750H (mm) made up of 18mm prelaminated board duly sealed with 2 mm PVC beading on all sides. Understructure made up of C frame with CRCAMS sheet of 0.9 mm thick, tublar frame of MS ERW round tube of dia 25.4mm x 1.2mm thick, Modesty panel made up of 1mm thick CRCAMS sheet. Storage made up of two drawer unit one side of the table with 0.5mm thick CRCAMS sheet of overall size 355.5 W x 5S9D x 433.5H	No	1		
54	<b>4</b>	<b>STEEL OFFICE ALMIRAH</b>				
55		Almirah As per Specs Tender Sizes standard office Almirah as per Tender Supplying fitting and installing Almirah Product Size : Plain 78 x 36 x 19 inches Construction and Materials & Welded construction. 0.8mm thick CRCA for back, Shelf & 0.9mm thick CRCA for all other components. Configuration (Door) height steel Hinged Door. Locking & handle handle 3 way locking mechanism with shooting bolt arrangement shelving: Height wise Adjustable Shelf Mounting. Uniformly Distributed Load Capacity per each full shelf is 80 Kg maximum. Plain 45:4 nos of adjustable full shelves. Leveler : M10 screw type leveler with hex plastic base. Finish: Epoxy Polyester Powder coated to the thickness of 50 microns (+/-10)	No	1		
56	<b>3</b>	<b>CANE CHAIRS WITHOUT ARM FOR VISITORS</b>	No	1		
57		<b>TOTAL</b>				
58		<b>GST</b>	<b>18%</b>			
59		<b>GRAND TOTAL</b>				
60	<b>In words</b>					
61						
62						
63						